

**NOTES:**  
 1) NO TITLE REPORT FURNISHED  
 2) THIS SURVEY DOES NOT PURPORT TO REFLECT ALL EASEMENTS AND/OR ENCUMBRANCES AFFECTING THE TITLE TO THE SUBJECT PROPERTY.  
 3) BEARINGS ASSUMED TO DENOTE ANGLES.

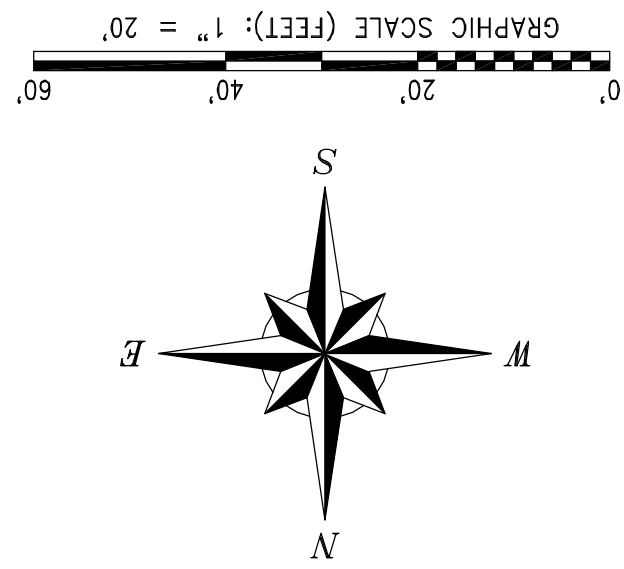

"Exhibit B To Ordinance 40-2005"

N/A  
 ADENA HEALTH SYSTEM  
 OFFICIAL RECORD 103, PAGE 122

CROOKED CREEK

RANDALL L. ROE  
 OFFICIAL RECORD 51, PAGE 528

ARC=230.26  
 RADIUS=488.87  
 $\Delta$ =27°05'3"  
 CHORD=228.13  
 BEARING=N 54°10'20" W

ARC=180.47  
 RADIUS=428.37  
 $\Delta$ =24°08'17"  
 CHORD=179.13  
 BEARING=S 55°36'37" E

178+46.93  
 86.11 LT  
 178+96.87  
 86.33 LT  
 PK-23-11-85-47.70

ARC=293.30  
 RADIUS=628.84  
 $\Delta$ =02°41'37"  
 CHORD=293.27  
 BEARING=N 17°19'45" E

PRIDE DRIVE  
 CONNECTOR

NORTH BOUND U.S. ROUTE 23  
 SOUTH BOUND U.S. ROUTE 23

AREA TO BE VACATED  
 U.S. ROUTE 23  
 0.2849 ACRES

AREA TO BE DEDICATED  
 PROPOSED SOUTH CONNECTOR  
 (60' WIDE)  
 0.4992 ACRES

- LEGEND**
- POINT
  - REBAR W/ I.D. CAP SET
  - ⊙ 5/8" REBAR W/ I.D. CAP SET
  - ⊙ IRON PIPE FOUND
  - ⊙ NOW OR FORMERLY
  - ⊙ BACK OF CONCRETE CURB
  - ⊙ FACE OF CONCRETE CURB
  - ⊙ FOCF
  - ⊙ EOP
  - ⊙ EOC
  - ⊙ EDC
  - ⊙ EDS
  - ⊙ ECS
  - ⊙ EX R/W
  - ⊙ R/W
  - ⊙ PROP RIGHT OF WAY

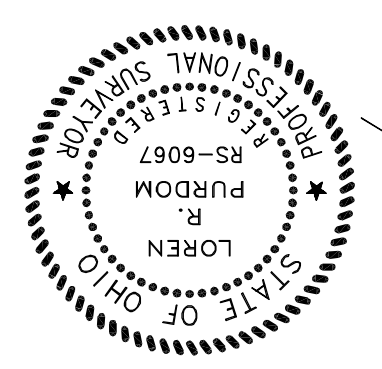

LOREN R. PURDOM  
 PROFESSIONAL SURVEYOR #6067  
 STATE OF OHIO  
 DATE:

SCALE: 1" = 20'HZ.  
 DRAWN BY: T. ROYAL  
 CHECKED BY: L. PURDOM  
 DRAWING NUMBER:  
 SHEET NUMBER

ON THE PROPERTY OF  
**RANDALL L. ROE  
 & U.S. ROUTE 23**  
 CITY OF WAVERLY, PIKE COUNTY, OHIO

**VACATION &  
 DEDICATION  
 PLAT**

**APX**  
 CONSULTING GROUP, LLC  
 Engineers & Surveyors  
 1606 Doywood Ridge Road  
 Waverly, OH 44150  
 Phone: (740) 574-2534  
 Fax: (740) 574-0009

| REV | DATE OF DRAWING | DESCRIPTION | DATE |
|-----|-----------------|-------------|------|
| 0   | 02/15/05        |             |      |